

YCCART 2023/Y15

**Cutting New Ground: The Little River
Part 3: The New Cut, Kingston Seymour**

**YATTON, CONGRESBURY, CLAVERHAM AND CLEEVE ARCHAEOLOGICAL
RESEARCH TEAM (YCCART)**

General Editor: Vince Russett



The New Cut and M5 from the Little River

Kingston Seymour and Yatton, Documentary, New Cut on Little River, 2023, Y15, v1.

Page	Contents
3	Abstract Acknowledgements Introduction
4	Site location Land use and geology
6	Historical & archaeological context
13	Recommendations References
14	Appendix – Documents in the case (1834)

Abstract

The New Cut at the lower end of the Little River was an unusual effort by the Wrington Commissioners of Sewers to undertake new engineering works for flood control purposes. Earlier efforts at Congresbury Great Moor around 1819, for example, had shown the Commissioners unable to initiate such a scheme (Cran 1980), and it has become an article of faith that this was always so; what made the difference here is not clear from the historic record, unless the involvement of the Smyth-Pigott family with their (?apparent) huge wealth influenced the outcome.

Acknowledgements

We are grateful to the unsung heroes who have maintained these waterways in their present form for centuries, paid or unpaid, official or not.

I would also like to thank the tireless work of the staff of the Somerset Heritage Centre, whose sometimes weary acceptance that many documents are in a poor state when they reach the Centre is acknowledged and sympathised with.

Introduction

Yatton, Congresbury, Claverham and Cleeve Archaeological Research Team (YCCART) is a Community Archaeology team working across northern Somerset.

Our objective is to undertake archaeological fieldwork to enable a better understanding and management of the heritage of the area while recording and publishing the activities and locations of the research carried out.

Correct me if I'm wrong, but you would think that if one nation ought by now to have mastered the science of drainage, Britain would be it - Bill Bryson

Site location



Fig 1: General Location



Fig 2: New cut Location

The New Cut is a nineteenth century extension of the Little River, from a point at ST39516526, a little above the former David's Ear sluice in Yatton parish, to the point where it joins the Congresbury Yeo at ST38976550 in Kingston Seymour, some 0.66km before rationalisation with the construction of the M5, but 0.64 km afterwards.

The whole lies about 4.5km south of the town of Clevedon, in the Local Authority of North Somerset.

Land use and geology

The land traversed by the New Cut is entirely within the TFDs (Tidal Flood Deposits) of the Northmarsh, specifically in this area grey alluvial clays. The one borehole in the area (BGS ST36NE1 1961) shows black peats beginning at a depth of 4.6m below the surface, and so not a consideration in the engineering of the New Cut, although the peats do outcrop at about 3m down not far away on the south of the Congresbury Yeo in the base of the Oldbridge River (*VR pers obs*).

The land is largely down to pasture. There is no public access to this area, although general views can be obtained from the footpath leading from Kingston village to the M5 subway next to the New Cut.

Historical & archaeological context

The Little River, clearly itself an artificial construction of some as yet unknown time(s) (see YCCART 2023a; YCCART2023b) has, since before 1528, debouched into the Congresbury Yeo at a clyce called David's Ear (*yere* = obsolete Somerset dialect for a clyce or notable sluice), a site being rebuilt in that year (Hobhouse 1890).

In the early 19th century, concern around flooding of fields close to Phipp's Bridge on the Kingston Seymour side of the Congresbury Yeo led to a decision by the Commissioners of Sewers to initiate works to build a 'New Drain' to a point lower down the Congresbury Yeo, leading to the abandonment of the Ear.

The surviving documents concerning this case and its complex and perhaps surprisingly democratic procedures are in the Somerset Heritage Centre (SHC D/RA\1\2/36). They illustrate something of the way such cases were locally dealt with: it is of interest that the Jury summoned contained no persons actually from Yatton or Kingston Seymour, but presumably we can recognise in the lists that element of slightly older, slightly better-off farmers who often fill such seats to this day (this is NO political judgement, simply an observation).

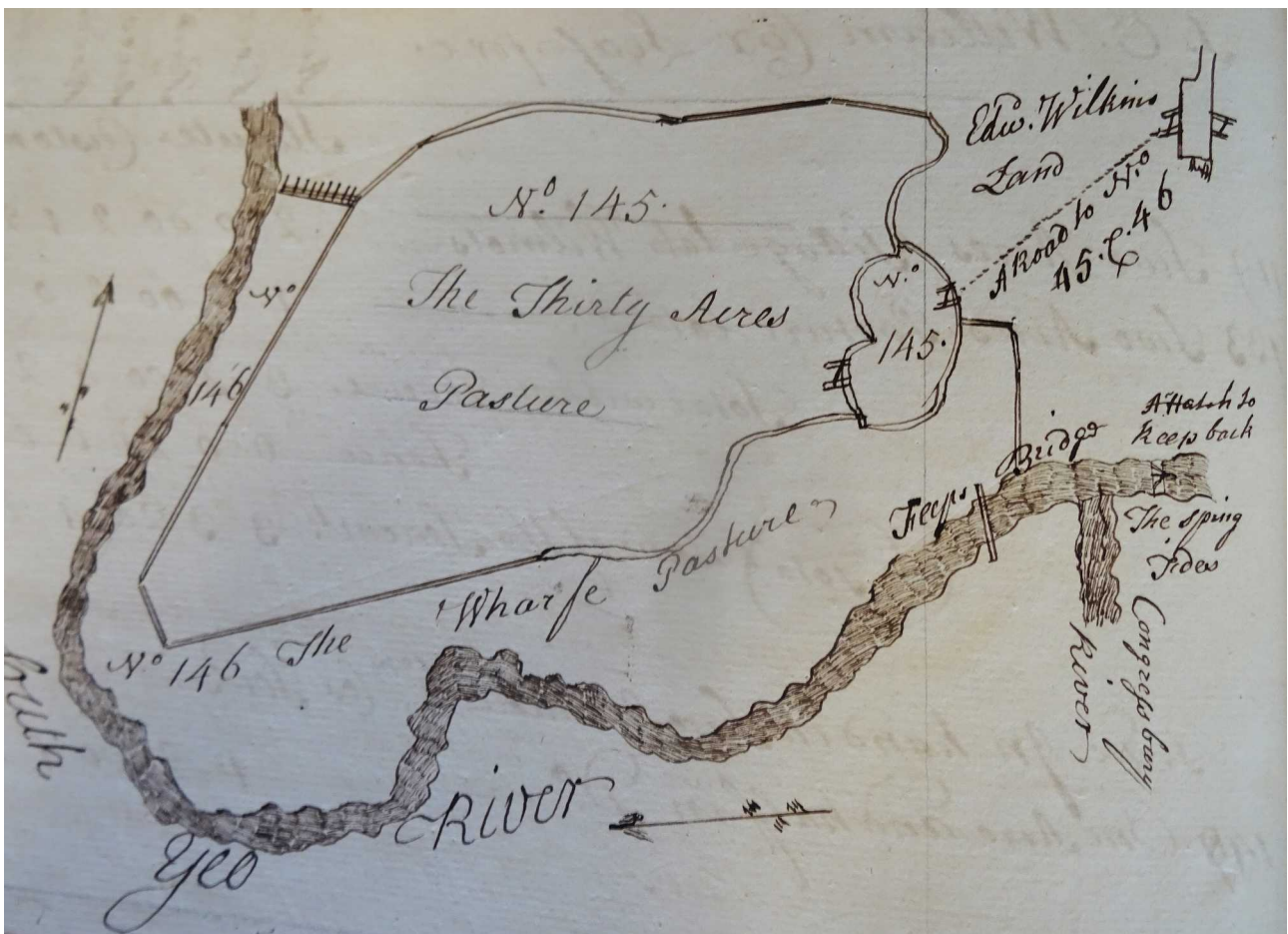

Fig 3: Location map of area, c 1780 (SHC DD\PT/H452/42), before any New Cut construction

Unfortunately, the plan referred to in the documents (see Appendix) does not seem to have survived, but references in the 1848 Commissioners document (YCCCART, forthcoming), the physical evidence on the ground, and lidar and aerial photographs make the position relatively clear (including the changes made with the construction of the M5 motorway). An earlier map of the area from c1780 (Fig 3 above) shows no New Cut, the end point of the Little River being bridged by a feature called 'A Hatch to/Keep back/The spring/Tides', which is presumably the surviving part (or more likely, the replacement for), the documented David's Ear. The nearby 'Feep's Bridge' (aka Phipp's Bridge, with repair costs going back to at least 1620 in the Queen Elizabeth's Hospital Accounts for Congresbury / Yatton) has been replaced (1957) with a sluice on the river on the same site: the modern footpath continues to use this somewhat clumsy river crossing.

The next significant map available in this area dates to 1821 (copy in Kingston Seymour in private ownership, original in SHC - A/CSF/1), Fig 4.



Fig 4: 1821 map of Phipps Bridge area of Kingston Seymour, courtesy of Jane Bell

This map, although it has some of the earliest depiction of riverside flood defences, does not show (in its original form) the waterway of the New Cut that survives today: closer inspection (and the use of clarification with Photoshop!) clearly shows the Cut as a pencilled addition to the map (Fig 5).



Fig 5: Note the 'New Drain' on the line of the New Cut added to the 1821 map

Oddly, the Kingston Tithe Map of c1846 (at least the version scanned for Know Your Place) does not show the New Cut, despite being published at least 12 years after the events below) (Fig 6), but equally confusingly, it *is* depicted on the trial version of the 1840 Yatton plan, where it is simply labelled 'River' (Fig 7), as well as the formal TM.

This may be the cause of Barraclough's dating of the construction of New Cut to 1841-6 (Barraclough 1991; she does not give primary sources for this).

Details within the Commission documents of 1834 give details of the construction itself:

'A certain new Sewer drain Clyse valve and other works which said / new Sewer or drain is intended to commence near a place in the Yatton River called Davids Ear in the parish of Yatton in the County aforesaid and to cross / a piece of pasture Land in the parish of Yatton aforesaid in the County aforesaid / belonging to John Hugh Smith Pigott Esquire thence entering an old ditch to / continue along the same between Lands in the Parish of



Fig 6: Kingston Seymour Tithe Map 1846

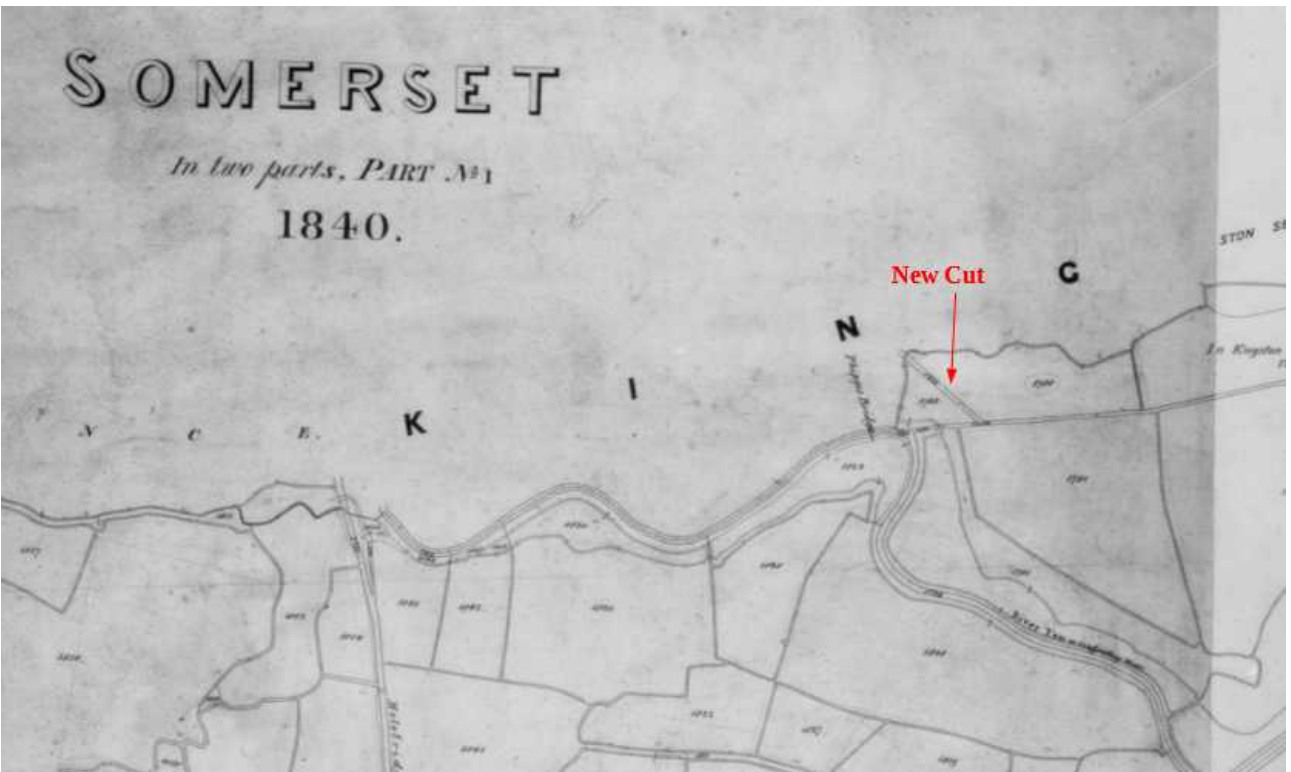

Fig 7: Trial of 1840 Yatton Tithe Map (New Cut arrowed)

Kingston Seymour and Yatton, Documentary, New Cut on Little River, 2023, Y15, v1.

Kingston Seymour / aforesaid in the County aforesaid belonging to Mrs Player and Lands belonging / to Mr Benjamin Griffen and a piece of pasture Land belonging to the said / John Hugh Smith Pigott Esquire then quitting the said old ditch to cross a / piece of pasture Land in Kingston Seymour aforesaid in the County aforesaid / belonging to the said John Hugh Smith Pigott Esquire called Pages 18 acres and / thence to pass under the sea wall and across a piece of Land also belonging / to the said John Hugh Smith Pigott Esquire called Pages Salt Wharf in / Kingston Seymour aforesaid in the County aforesaid into the River at a place a / little North westward of Pages Rails.

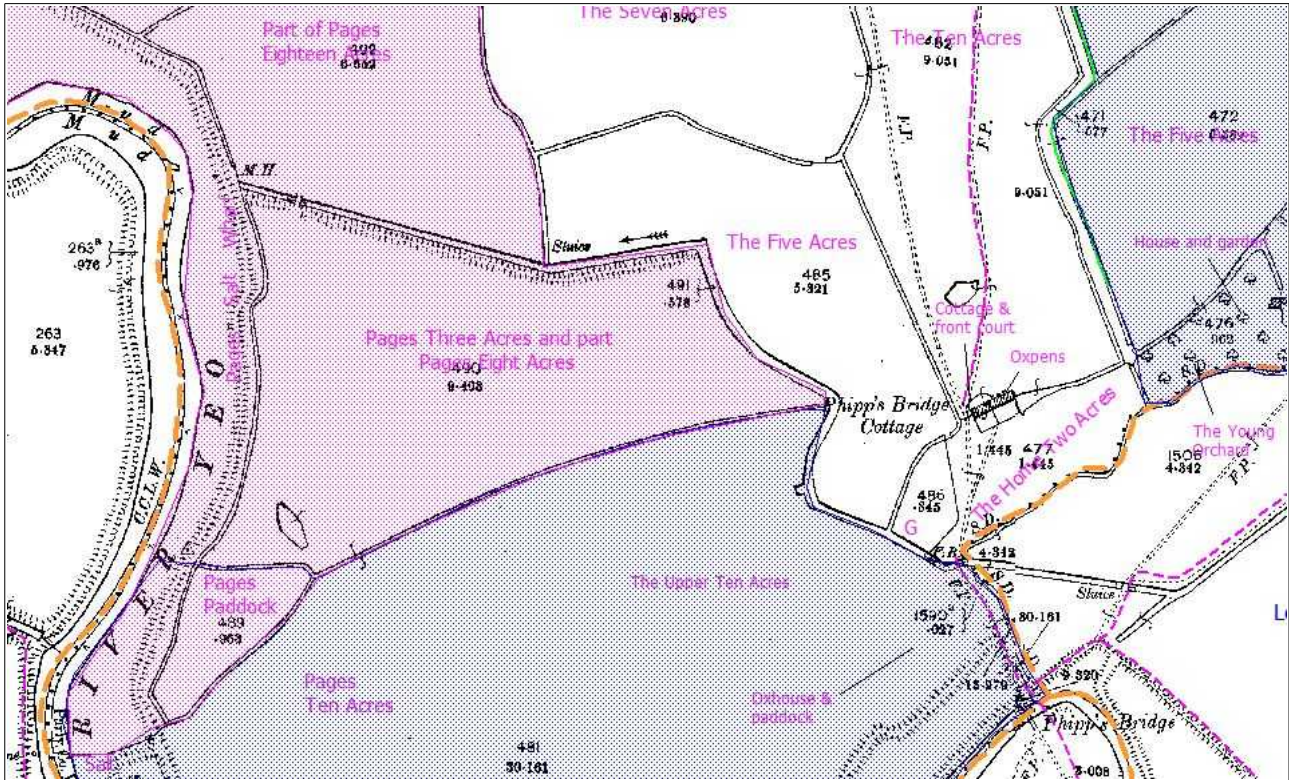

Fig 8: Fieldnames from Tithe Maps; pink and blue shades land under ownership of the Smyth-Pigott family

Presumably there had been previous discussions about the likelihood (or actuality of) flooding in the local fields, and the construction of the New Cut was to cut off the loop of the Congresbury River and hopefully increase the flow rate in the Little River, with concomitant effects upstream as well.

Lidar shows little difference between the 'grass level' at either end of the New Cut, but presumably the deeper size of the river downstream was thought to be able to increase the flow rate, especially at low tide. Comparing the text to the field names from the local Tithe Maps, the name 'Part of Pages Eighteen Acres' survives, now marking a very much smaller field. 'Pages Salt Wharf' is similarly marked.

The line of the 'New Drain' and the sections of 'Old Ditch' can be clearly seen by comparing (for example) Figs 4 and 8 above. Presumably the 'old ditch' included would have had to have been enlarged to the same scale as the new works.

Unfortunately, we apparently have no clear indication of the dates, times or methods of the actual construction (something this project shares with almost all earlier water management engineering), except that at least the Yatton part seems to have been in place by the drawing up of the draft Tithe Plan dated 1840 (Fig 7 above), which does raise the problem of why it is not depicted on the Kingston Tithe Map of (purportedly) 1846.

It seems much more likely that once the pretty conclusive decisions had been made (see Appendix) that the work would take place fairly quickly, so as to attempt to avoid further winter floods.

Barraclough (1991: 56) gives 1846 as a definite *terminus post quem*:

At that time the Little River flowed into the Yeo at Phipps Bridge and Fig. 14 makes it clear why so much money and time was spent by Yatton parish on the maintenance of David's Ear (Chapter 13). The hatch there was to keep the salt water out of the Little River. At some time this river had been straightened; the parish boundary follows its old course.

David's Ear was still in use in 1841 but between then and 1846 the Little River ceased to flow through it into the Yeo at Phipps Bridge. A Commissioners' survey of 1848 says that the Little River [see YCCART 2024, forthcoming] goes under the bow at Wemberham Farm (now demolished) to the River Yeo, but joins the New Cut there, between fields numbered 1788 and 1789 on the tithe map. It then goes due west along the New Cut in Kingston Seymour and terminates at an outlet in the river at Salt Warth. The work must have been completed by 1846 because in that October a Mr. Gage was to be paid £3.3.0. a year for keeping the New Cut in proper repair and attending to the hatches.

The subsequent history of the New Cut can be followed on the OS maps for the area. Along with the obliteration of any trace of the former hamlet in the area, the construction of the M5 in 1969-72 resulted in the re-alignment of a stretch of the Cut to run under the motorway (Fig 9).

At various dates, the Cut has been shown with banks alongside, but there seems no consistency in these, and unfortunately, other Commissioners documents (for example, dealing with costal merestones) are not detailed enough to know how far the New Cut was incorporated in their descriptions.

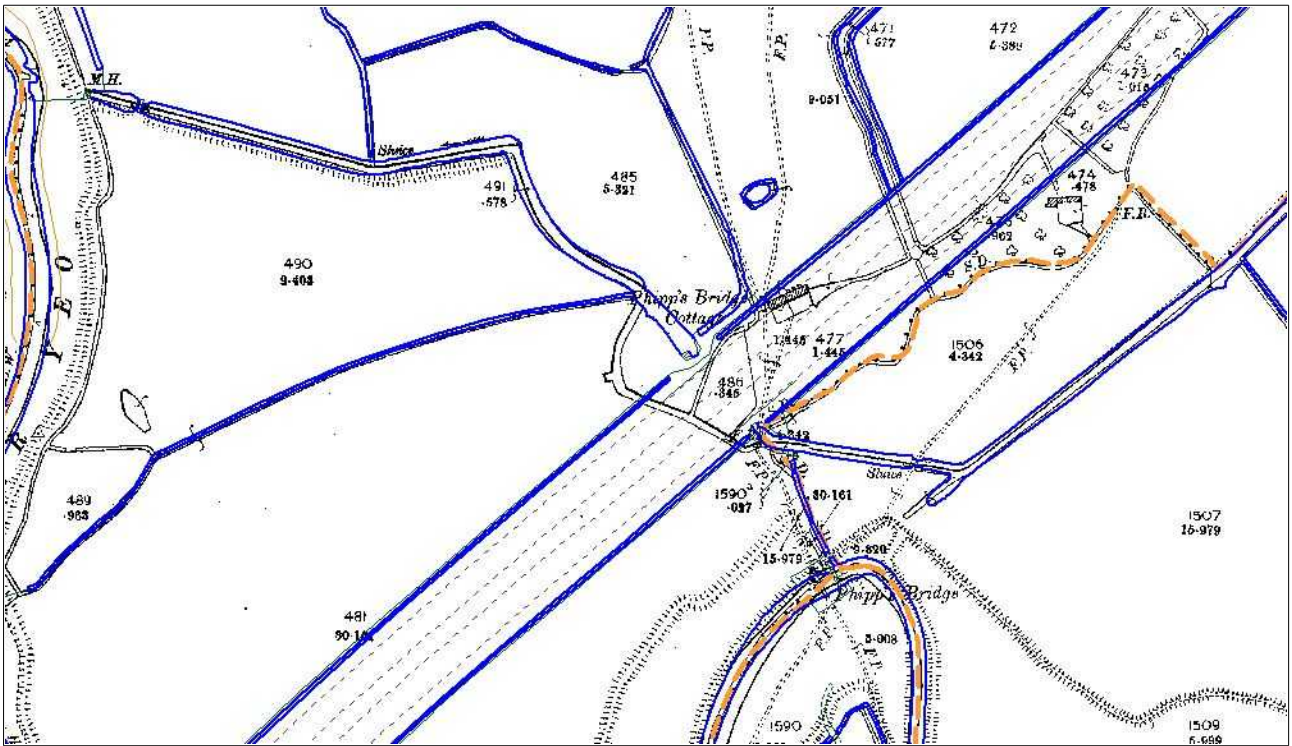

Fig 9: Realignment of the New Cut, c1970 (modern water in royal blue). Base map OS Epoch 2 (c1900)



Fig 10: New Cut and M5 from NW (2018)

Recommendations for further work

The reasons for the differences in approach between this scheme, and that which eventually resulted in Rennie's scheme for draining Congresbury Great Moor (YCCCART 2017) are not clear, although it must always be suspected that the input of the Smyth-Pigott family was consequential here.

The existence of the Inquisition and Rate (below) shows clearly that the Commissioners were quite capable of promoting such schemes, so the difference remains mysterious.

References

Barraclough, M. 1991	<i>A history of Yatton</i> , Yatton Local History Society
Cran, A. 1980	<i>A history of Congresbury</i> , Bristol
Hobhouse, Rt Rev 1890	<i>Churchwardens accounts of Crocombe, Pilton, Yatton, Tintinhull, Morebath and St Michael's Bath</i> Somerset Record Society
YCCCART 2017	Gang Wall, Yatton and Rennie's siphon, Congresbury <i>Available at YCCCART.co.uk</i>
YCCCART 2023a	Managing the waters: The Yatton Little River Part 1: Sluice Stile to the Boarden Bow <i>Available at YCCCART.co.uk</i>
YCCCART 2023b	Marking the boundaries: The Yatton Little River Part 2: Boarden Bow to Congresbury Yeo <i>Available at YCCCART.co.uk</i>
YCCCART 2024, forthcoming	Managing the flood in 1848: The Wrington Jury of Sewers records <i>Available at YCCCART.co.uk (2024)</i>

Authors

Vince Russett

Date

2023-12-15

Appendices 1: The papers in the case

Impanelled Jury (SHC D/RA\1\2/36)

[DSC09118]

The names of the Jurors impanelled sum[----
and returned for the Purposes mentioned in the [---
annexed Precept.

√	1	William Bathe of Wrington, Farmer	2	sum
√	2	Abraham Carter of Wrington, Carpenter	3	sum
√	3	John Inner Foster of Wrington, Tailor	4	sum
√	4	Richard Høuse Hurse of Wrington, Farmer	5 14	sum
√	5	Silvester Jones of Wrington, Farmer	5	sum
√	6	Frederick Knowles of Wrington, Carpenter	1	Foreman sum
√	7	James Lawrence of Wrington, Butcher	6	sum
√	8	John Parker Maine of Wrington, Plumber	7	sum
√	9	Thomas Masters of Wrington, Carpenter		<i>dis</i>
√	10	George Morgan of Wrington, Inn keeper	8	sum
√	11	Henry Noble of Wrington, Tiler and Plasterer	9	sum
√	12	Joseph Theyer of Wrington, Saddler	10	sum
√	13	Joseph Board of Berrow, Gentleman	11	sum
√	14	George Counsell of Berrow, Farmer	12	sum
√	15	Cornelius Harris of Berrow, Gentleman	13	sm
√	16	Richard Hodges of Berrow, Carpenter		
	17	Simon Hooper of Berrow, Gentleman		
√	18	Joseph Palmer of Berrow, Farmer	15	sum
ill	19	Thomas Barnes of Burrington, Farmer		
√	20	Thomas Buxton of Burrington, Farmer	16	sum
√	21	Samuel Heal of Burrington, Farmer	17	sum
√	22	John Keel of Burrington, Gentleman	18	sum
	23	Joseph Lucas Lovell of Burrington, Gentleman		
		<i>Francis Popham Esquire Sherrif</i>		

The Execution of this Precept appears by the / Panel hereunto annexed / The answer of Francis Popham Esquire, Sheriff

Discussion

The panel consists of 12 inhabitants of Wrington, 6 of Berrow and 5 of Burrington. 8 are 'farmers', 5 are gentlemen, but a surprising number are of those in trades not directly related to agriculture. Without comparison, it is not possible to tell if this is a typical Commissioners Jury.

It was set up under the following precept (SHC D/RA\1\2\36):

Somersetshire

(Court)

To the Sheriff of the said County, or his lawful Deputy - Greeting

We whose names are hereunto subscribed and Seals / affixed Commissioners of Sewers) amongst others) in and / further said County. three of whom are of the Quorum / Do hereby in His Majesty's name and by the virtue of / a Commission under the Great Seal of Great Britain to / us and others directed authorize and require you / forthwith to cause to be impanelled summoned and / returned Twenty three substantial and indifferent / persons within your jurisdiction qualified and / usually Summoned to serve on Grand Juries and / Courts of Sessions of the Peace personally to be and / appear before us or other Commissioners of Sewers for the / said County at the House of Thomas Webb / Commonly called or known by the name of the / Golden Lion Inn at Wrington in the said County / on Friday the Thirtieth day of May instant by / Eleven of the Clock of the forenoon of the same day / to Enquire on behalf of our Sovereign Lord the King / and Presentment make of all such matters and / things as shall - then and there be given them in Charge / Concerning the Sewers within the said County, and / have you then and there the names of the said Jury / and this Precept - Given under our hands and Seals / the sixteenth day of May in the year of Our Lord one / thousand eight hundred and thirty four

Saml Baker [seal] Jno Ca[---] [seal]

John Baker [seal] John Bennett [seal]

[-----] [---] [seal] Tho P[---] [seal]

[-----] [---] [seal] [---] [---] [seal]

This was externally labelled:

Somersetshire Sewers

Precept to Sheriff to
summon Jury

To Wrington
30th May 1834

The actual charge to this jury was detailed, and tells us much of the workings of such juries:

Charge to the jury

Gentlemen of the Jury

At a Session of Sewers holden at the Golden Lion Inn in Wrington / in and for the County of Somerset the 25th day of April last application was made / to the Commissioners of Sewers of the said County to order certain new works to be made and executed for the improvement of the drainage of certain Lands lying in / the several parishes of Yatton Kingston Seymour and Kenn in the said County / videlicet A certain new Sewer drain Clyse valve and other works which said / new Sewer or drain is intended to commence near a place in the Yatton River called Davids Ear in the parish of Yatton in the County aforesaid and to cross / a piece of pasture Land in the parish of Yatton aforesaid in the County aforesaid / belonging to John Hugh Smith Pigott Esquire thence entering an old ditch to / continue along the same between Lands in the Parish of Kingston Seymour / aforesaid in the County aforesaid belonging to Mrs Player and Lands belonging / to Mr Benjamin Griffen and a piece of pasture Land belonging to the said / John Hugh Smith Pigott Esquire then quitting the said old ditch to cross a / piece of pasture Land in Kingston Seymour aforesaid in the County aforesaid / belonging to the said John Hugh Smith Pigott Esquire called Pages 18 acres and / thence to pass under the sea wall and across a piece of Land also belonging / to the said John Hugh Smith Pigott Esquire called Pages Salt Wharf in / Kingston Seymour aforesaid in the County aforesaid into the River at a place a / little North westward of Pages Rails the whole of such new works being within / the Limits of the said Commission and to issue a Precept to the Sheriff of the / said County to summon a Jury from the body of the said County to make / such enquiry and presentment in the premises as to them should be / given in charge.

You are therefore to enquire into and present what the costs and / making and executing such new works will amount to, and what / Messuages Lands Tenements or Hereditaments within the limits of the said / Commission will receive benefit or avoid damage by the making and / executing of the said new works, and who in particular are the owners and / occupiers of the said Messuages Lands Tenements or Hereditaments respectively / also who are the persons fit to be charged to the makings and executing of the / said new works with the quantities and qualities of their Estates respectively / that all such persons may be charged and taxed in proportion to their rights / and interests therein and to the damage which they will avoid and the /

[DSC09114] - [DSC09117]

benefit which they will receive by the said New works, also (who are) the persons / ~~who are~~ fit to be charged to the maintaining and repairing the said new / works after they have been so made and executed. - You are also / to Enquire into and present whether three fourths in value of the owners / and occupiers of the Messuages Lands Tenements and Hereditaments / proposed to be charged with the costs and expensing of making and / executing such new works have consented that new works shall be / so made and executed and whether such consent hath been certified in / writing to this Court.

These meetings were held at the Golden Lion Inn in the Parish of Wrington and the Railway Hotel Yatton.

The origination of this process was a meeting in January of that year, by the actual landowners involved:

[DSC09144] [Cover note]

Yatton ^{Kenn & Kingston Seym} Drainage
Authority of Court of
Sewers from thence [fou--]
parts in value of owners
of Lands presented to be
charged

[DSC09146]

At a Meeting held at the Nelson Inn, Cleeve in the / parish of Yatton in the County of Somerset the 21st / day of January 1834

We whose Names are here subscribed, owners / and Occupiers of Low Lands situate in Kenn Moor / and the Parish of Yatton aforesaid, that are liable / frequently to be flooded and are at this time / chiefly under Water, have Resolved

That the Plan now produced by Mr John Millard / Tucker for improving the Drainage of the before mentioned / Lands appears to us to be effectual for the purpose / intended And that the same may be just in / operation We as Owners of more than three fowerth / parts in Value of the Lands to be charged for the Costs / of Carrying the same into effect Do hereby authorize / and empower the Court of Sewers acting in and for / the Northern Division of the County of Somerset At the / next Court of Sewers to be holden at Wrington on the / 27th day of January Instant or any subsequent Court to take into the Jurisdiction / of the said Court the Making of the Tunnel New Drain / and other Works connected therewith as shown by the / said Plan, And to order and direct by whom and in what / rateable Proportions the works shall be executed and / hereafter Kept and maintained And to make each / Orders and directions therein as to the said Court shall / seem meet.

That Mr Tucker do attend the said Court to / explain the proposed Works.

We recommend Mr Tucker be appointed , if the / Court shall see fit, the Surveyor and Inspector of the Works.

[DSC09150]

As Agent to John Hugh Smyth Pigott Esqr /

Sam Baker
James Tucker
Jno Griffin
John Bennett
Thos. L Edwards
A J Tanner
Saml Baker

Bishop Gregory
Robert Williams
Fr Manning
Edwd Gregory
Richd Broackes
William Say
William Say Junr
J M Tucker
Robert Bryant for Mary Hunt
Maurice Gregory
Jno Cox
William L[---]
Agent to Revd John Boak
Joseph Fisher

[DSC09152]

30th May 1834 I John Millard Tucker [---] / hereby certify that the persons who have signed [--] / the foregoing authority and consent according to / the statute are [---] more than three fourths / in value of the owners and occupiers of the Lands / proposed to be charged with the expenses of the / intended new works /

J M Tucker

Somerset

Yatton Kingston Seymour and

Kenn Moor Drainage

Inquisition
and
Rate

Somerset (to wit) **An Inquisition** taken at a Session of Sewers holden at the Golden Lion Inn in Wrington in the County of Somerset and within the limits of the Commission of Sewers hereafter mentioned on Friday the thirtieth / day of May in the fourth year in the Reign of Our Sovereign Lord William the Fourth by the Grace of God of the United Kingdom of Great Britain and Ireland King defender of the faith and in the year of Our Lord One thousand and eight hundred and thirty four / before George Emery Esquire Chairman, Thomas Tutton Knyfton, Samuel Baker, Robert beakes Simmons, John Blackburrow, Thomas Phillips Cox Thomas Blackburrow, John Bennett and others their Companions, All of them duly sworn his Majesties Justices and / Commissioners of Sewers (three whereof are of the quorum) among others assigned for the County of Somerset by virtue of a Commission of Sewers under the Great Seal of the United Kingdom of Great Britain and Ireland to them and others directed and / bearing date at Westminster the twenty third day of January in the Sixth year of the Reign of his late Majesty King George the fourth Upon the Oaths of Frederick Knowles, William Bathe, Abraham Carter, John Foster, Richard Harse, Silvester / Jones, James Lawrence, John Parker Maine, George Morgan, Henry Morgan, Henry Noble, Joseph Thayer, Joseph Beard, George Counsel, Cornelius Harris, Joseph Palmer, Thomas Buxton, Samuel Heale and John Keel, good honest and lawful men of the said / County of Somerset who being returned and charged before and by them the said Justices and Commissioners to enquire into and present for our Sovereign Lord the King what the costs and expenses will amount to of making and executing certain new works for / the improvement of certain Lands lying in the several parishes of Yatton Kingston Seymour and Kenn in the said County *videlicet* A certain new Sewer Drain Clyse Valve and other works which said new Sewer or Drain is intended to / commence near a place in the Yatton River called David's Ear in the parish of Yatton in the County aforesaid and the cross a piece of Pasture land in the Parish of Yatton aforesaid belonging to John Hugh Smith Pigott Esquire thence / entering an Old ditch to continue along the same between lands in the Parish of Kingston Seymour aforesaid in the County aforesaid belonging to Mrs Player and lands late belonging to Mr Benjamin Griffin and a piece of pasture belonging to the John Hugh / Smith Pigott Esquire then quitting the said Old ditch to cross a piece of Pasture Land in Kingston Seymour aforesaid in the County aforesaid belonging to the said John Hugh Smith Pigott Esquire called pages Eighteen acres and thence to pass under the Sea Wall and across a / piece of land also belonging to the said John Hugh Smith Pigott Esquire called Pages Salt Wharf in Kingston Seymour aforesaid in the County aforesaid into the River at a place a little Northwestward of Pages Rails, the whole of such New works being within the limits / of the said Commission. And what messuages lands tenements or heriditaments within the limits of the said Commission will receive benefit or avoid damage by the making and executing of the said New works, and who in particular are the Owners and occupiers / of the said Messuages lands tenements and hereditaments respectively, also who are the persons fit to be charged to the making and executing of the said New works with the quantities and qualities of their estates respectively that all such persons may be / charged and taxed in proportion to their rights and interests therein, And to the damage which they will avoid and the benefit which they will receive by the said New works Also who are the persons fit to be charged to the maintaining and repairing the said / new works after they have been so made and executed. And also to enquire into and enquire whether three fourths in

472	"	"	The Low Ground	4	3	39		18	
				6	3	20	1	1	11
81	Atherton, William	Frederick Blue	Kenn Moor	4	2	27	-	-	-
82	Bristol Corporation	John Young	Kenn Moor	5	0	16	1	2	11
446	"	"	West Mead		2	15		15	2
678	"	"	Munmead	5	0	16	6	2	5
663	"	"	Batch	4	0	2		7	6
704	"	William Day	In Vast Croft		2	20		6	6
				15	1	29	8	14	6
104	Boak, Rev Mr	Brooks and others	Kenn Moor & Decoy	50	3	6	71	13	8
105	"	"	"						
106	"	"	"						
107	"	"	Kenn Moor	33	1	12	49	19	9
114	"	John Manning	"	9	0	32	6	18	9
132	"	William Baber	"	9	0	18	2	14	8
134	"	Francis Rogers	"	2	2	20	"	15	9
				105	0	8	132	1	10
443	Brooks, Richard	John Baker	Withey Bed	1	0	11	1	4	0
408	Baker, Samuel	Himself	The Paddocks	2	3	39		18	0
409	"	"	"						
410	"	"	"						
411	"	"	The 5 acres or Tying	3	3	36	1	2	6
				6	3	35	2	0	6
54	Culliford (late)	James Pool	Kenn Moor	3	1	28	1	5	8
55	"	Edward Wall	"	4	2	11	1	14	3
682	"	George Wilson	Moor Street & Allotment (late Cullifords)	3	1	9	4	4	3
683	"	George Wilson							
				11	1	8	7	4	2

57	Curtis, Mrs	Job Wilson	Kenn Moor	4	2	11	1	14	3
101	Cox, John	Late Thomas Vowles	Kenn Moor	9	0	35	12	8	11
447	"	James Chedzey	Westmead	3	1	3	4	18	0
				12	1	38	17	6	11
45	Dawbeny, Rev Mr	Joseph Pool	Kenn Moor	5	2	9	2	1	7
52	"	James Clark	"	4	3	11	2	3	5
				10	1	20	4	5	0
59	Edwards, William	Job Wilson	Kenn Moor	4	1	27	1	13	2
40	Edwards, Lyddon	Samuel Young	Kenn Moor	4	2	24	0	13	11
76	"	Samuel Young	"	12	0	13	13	11	9
77	"	& John Young	"						
78	"	John Young	"	5	2	34	6	17	2
88	"	Samuel Young	"	6	3	4	10	3	3
				29	0	35	31	6	1
61	Fisher, Joseph	George Wilson	Kenn Moor	4	1	18	3	5	5
62	"	John Hawkins	"	4	1	18	3	5	5
112	"	Mrs Ford	"	9	0	35	6	18	3
133	"	"	"	9	0	14	2	14	6
135	"	"	"	8	3	31	2	13	8
110	"	James Petheram	"	9	0	35	11	1	3
445	"	"	Westmead	1	0	29	1	10	0
				46	1	20	31	8	6
	[DSC09172								
359	Ford, widow	William Ford	Westmead	5	0	29		6	9
366	"	"	Horse Croft	2	2	28		8	0
368	"	"	Horse Croft						

435	"	"	Westmead	1	3	36	1	12	8
436	"	"	"	1	0	23		17	2
				10	3	36	3	4	7
3	Gregory, Maurice	Himself	Moor Street	1	1	0	1	17	6
458	"	"	Cold Harbour	3	0	10	4	11	11
				4	1	10	6	9	5
680	Gregory, Edward	John Young	Munmead	1	1	5	1	18	5
89	Gregory, Bishop	Edward Doggett	Kenn Moor	7	0	18		16	0
713a	"	William Jones	Great Search	4	3	3	1	4	0
713b	"	"	Part of Summerleaze	1	3	29			
677	"	Edward Doggett	Moor Street 3 acres and allotment	4	0	20	5	5	2
				17	3	30	7	5	2
12	Goldwyer, W. H.	James Blue	Kenn Moor	4	2	2		16	11
66	"	James Parsons	"	18	0	28	21	16	3
67									
68									
638	"	"	Withey Bed	2	3	11	1	5	5
				25	2	1	23	18	7
69	Galton, J.	Widow Jones	Kenn Moor	5	3	35	6	14	3
70	"	"	"	18	1	36	20	15	8
71									
72									
679	"	John Young	Munmead	1	1	5	1	18	5
649	"	Samuel Baker	Home ground	3	1	25	3	6	5
				29	0	21	32	14	9
	[DSC09168]								

73	Garrick, F C	Samuel Perry	Kenn Moor	18	3	6	21	2	9
74									
75									
84	Griffin, John	Henry Griffin	Kenn Moor	5	2	0	3	6	0
44	Harris, widow	John Parsons	Kenn Moor	6	0	6	2	5	3
46	Hatcher, Edmund	John Hawkins	Kenn Moor	5	2	10	2	1	9
47	Hill, William	Himself	Kenn Moor	5	2	0	2	1	3
434	"	"	Stallards 4 acres	3	1	19	2	0	5
				8	3	19	4	1	8
48	Hill, Peter	Himself	Kenn Moor	5	1	0	1	19	5
469	Hunt, Mrs	Nathaniel Ainsworth	West mead 3 acres	2	1	0	2	7	3
468	"	"	Six acres	4	3	2	6	8	8
864	"	"	Biddles Pitts	2	1	39	3	7	3
463	"	"	The three acres	2	2	6	3	8	6
461	"	"	Bear Garden	2	1	34	3	6	6
460	"	"	The Five Acres	1	2	18	2	3	6
444	"	"	Westmead	1	0	24	1	7	8
				17	1	3	22	9	4
89	Johnson, Mr	Job Wilson	Kenn Moor	7	2	12	11	7	3
773a	Jones, Thomas	Thomas Vowles	Horse Leaze	4	2	17	1	7	8
7	Lloyd, Job	George Wilson	Kenn Moor	3	2	20		5	5
681	Norman, John Esq	John Young	Lower Ground	1	0	25	1	6	0

10	Pigott, J H S, Esq	James Blue	Kenn Moor	4	2	22		17	5
49	"	John Hawkins	"	5	0	35	1	19	2
50	"	"	"	4	3	18	1	16	6
51	"	"	House & Kenn Moor	6	0	32	1	17	2
53	"	"	Kenn Moor	4	3	30	2	11	11
79	"	James Gage	"	5	2	34	5	11	5
85	"	"	"	7	3	11	8	4	2
86									
87	"	Edward Wall	"	3	1	34	5	3	11
90	"	James Parsons	"	8	0	24	12	4	6
92	"	Samuel Warne	"	24	3	23	37	6	9
93	"	"	"						
94	"	John Hawkins	"						
95	"	"	"						
96a				8	1	12	11	4	9
96b	"	"	"	7	1	3	9	5	5
97	"	Henry Wilson	"	8	1	8	10	11	8
98	"	Samuel Drissell	"	7	2	36	9	17	0
99a	"	James Blue	"	7	2	30	5	15	3
100	"	"	"	8	1	35	11	8	8
102	"	"	"	9	0	35	13	16	6
103	"	"	"	6	3	9	10	4	2
108	"	Himself	" Plantation	7	0	29	10	15	5
109	"	"	" "	9	0	35	13	16	6
99c	"	James Blue	Kenn Moor	9	0	6	6	15	6
111									
115	"	Isaac Mulford	"	7	2	2	5	12	8
116	"	John Bishop	"	14	2	16	21	18	0
117									
124a									
118 to 123	"	John Manning	"	30	0	2	42	15	5

124b	"	John Bishop	"	17	2	10	23	6	11
125									
126									
127 to 131	"	John Manning	"	45	2	12	13	13	5
136	"	Isaac Mulford	"	8	2	19	2	11	9
137	"	Charles Hill	"	14	0	25	4	4	11
138									
156	"	James Blue	"	20	1	20	7	12	9
157									
158									
159	"	John Lyons	"	8	0	14	4	17	0
161 to 165	"	"	"	39	1	0	31	15	8
381	"	John Bishop	Westmead	2	0	37	0	6	0
407	"	William Hill	Westmead 2 acres	1	1	25		16	11
459	"	John Lyons	Low Ground	4	0	8	3	15	0
454	"	"	Cold Harbour	2	3	29	4	7	11
455	"	William Lyons	"	1	2	0	2	5	0
685	"	John Lyons	Moor Street	1	0	22	1	14	2
5									
			Carried up	375	0	22	362	17	2
	[DSC09171]								
686a	Pigott, J H S Esq.	John Lyons	In Vast Croft	4	3	27	6	1	9
686b	"	"	"	5	0	0	5	12	6
702	"	"	Turners Cold Harbour	5	0	27	3	17	6
703	"	William Day	In Vast Croft	1	3	0		18	5
705	"	"	"	4	1	22	1	6	5
712b	"	"	Vast Croft 8 acres	6	1	8		13	6
771	"	John Lyons	Clayells	4	0	39	3	3	8
775	"	Isaac Mulford	Longmans Withey Bed	3	3	23	1	15	0
676	"	John Lyons	Thousand acres		2	10		8	5

				411	1	18	387	5	5
438	Parsons, Mrs	Robert Baker	Westmead	2	0	12	1	17	5
439	"	"	"						
712a	"	Robert Baker (Kenn)	Vastcroft 10 acres	8	0	6	2	8	3
				10	0	18	4	5	8
170	Quakers Land	Maurice Gregory	Kenn Moor	3	1	35	5	4	0
457	"	"	Cold Harbour	1	0	21	1	13	11
683a	"	"	Westmead	6	1	30	9	13	2
683b									
				11	0	6	16	11	1
42	Richards, Thomas	Himself	Kenn Moor	5	1	26	2	0	8
91	"	"	"	8	1	13	12	9	11
60	Say, William et al	John Edington	"	4	1	21	1	12	11
113	Spencer, Mrs	Mrs Ford	"	9	0	35	6	18	3
63	Say, William, Sr	John Griffen	"	6	1	3	6	11	8
64	"	"	"	11	0	23	11	14	0
65	"	"	"						
				17	1	26	18	5	8
154	Seymour, Mr	Bishop Gregory	Kenn Moor	13	0	17	2	9	2
155									
774	"	"	Horse Leaze	3	1	11		19	11
650	"	Richard Bishop	The 8 acres	6	3	9	6	12	9
				23	0	37	10	1	10
11	John Bennett	William Burge	Kenn Moor	4	1	25		19	11

56	"	"	"	4	2	11	1	14	3
647	"	"	Low Ground	4	2	26	4	10	11
648									
				13	2	22	7	5	1
13a	Tucker, J M	William Say	Kenn Moor	7	0	0	2	12	6
43	Tilly, Jane ^{Thos} Richards	Samuel Warne ^{Himself}	Kenn Moor	5	2	29	2	2	8
58	Tucker, James	Joseph Mitchell	Kenn Moor	4	2	18	1	14	8
406	"	Himself	Stallards 6 acres	4	3	20	2	11	2
661	"	John Young	Crosses	4	0	31	2	10	3
662	"	"	"	6	3	33	10	8	8
				20	2	22	17	4	9
166	Tanner, Arthur	Edward Gregory	Kenn Moor	5	3	29	6	3	6
167	"	"	"	9	0	17	8	10	6
168									
169									
772a	"	Bishop Gregory	Lower Hillsey	5	3	7	1	14	9
				20	3	13	16	18	9
83	Wall, William (late)	Culliford	Kenn Moor	5	0	16	1	10	8
398	Wickham, Miss	Robert Baker	Little Grammars Butts	2	0	26		9	0
397	"	"	Windey Close	3	2	23	1	7	9
399a									
399b	"	Samuel Baker	Westmead	2	2	1		18	9
403	"	"	Oxhouse field	3	0	22		12	0
405	"	"	Westmead	3	0	28	1	8	6
				14	2	30	4	16	0

433	Williams, Robert	Robert Williams Jnr	The 4 acres	2	3	36	1	15	9
470	"	"	Reeves 4 acres	3	2	3	3	3	3
				6	1	39	4	19	0

This resulted in an order from the Jury meeting:

Yatton Drainage

Notice is hereby given that a Jury returned impanelled and sworn for the County of / Somerset having met at the Golden Lion Inn in the parish of Wrington in the County aforesaid on / Friday the thirtieth day of May last pursuant to Public Notice given in the Newspapers / and on the Church Doors of the several parishes of Yatton Kingston Seymour and Kenn in the / County aforesaid and having enquired into and heard evidence on the several matters and / things then and there given them in charge on their Oaths presented that the costs and / expenses of making and executing certain intended new works in their Inquisitions or / presentment particularly set forth and described for the improvement of the drainage / of certain lands lying in the said several parishes of Yatton Kingston Keymour and / Kenn in the County aforesaid would account to the sum of Nine hundred and five / pounds seventeen shillings and one penny and that all the messuages lands and tenements and / hereditaments situate lying and being in the said several parishes of Yatton Kingston / Seymour and Kenn in the said County which are specified in the Schedule under / their said inquisition or presentment written would receive benefit or avoid damage / by the making and executing the said intended new works, and that the same messuages / land tenements and hereditaments respectively were all within the limits of the said / Commission And the said Jurors on their oaths further presented and said that the / several persons named in the said Schedule thereunder written were the owners / and occupiers of the said messuages lands tenements and hereditaments respectively and / that the owners of the said messuages lands tenements and hereditaments were the persons / fit to be charged in the making and executing of the said new works, and that the quantities / and qualities of their Estates and the proportion in which they ought to be taxed to the / Costs and expences of making and executing such new works were set opposite and / following the names of such owners respectively and were numbered with reference / to a Map made thereof by John Millard Tucker Land Surveyor and produced to the said / Jurors and that the Occupiers for the time being of the same messuages lands tenements / and hereditaments respectively were the persons fit to be charged and in the like / proportions to the maintaining and repairing the said new works after they / should have been so made and executed, And the said Jurors on their oaths further / presented that three fourths in value of the owners and occupiers of the said messuages

[DSC09087]

lands tenements and heriditaments so proposed to be charged with the costs and / expenses of making and executing such new works had consented that such new works / should be made and executed and that such consent had been produced to the said / Jurors and certified in writing to the Court. Notice is hereby given that a copy / of the said Inquisition or Presentment will be lying at the Dwellinghouse of John / Manning situate at Claverham in the Parish of Yatton aforesaid for the inspection of / the parties interested for fourteen days from the date hereof and that all Persons aggrieved / thereby may appear at an adjourned Session of Sewers to be holden at the Golden Lion /

Inn in Wrington aforesaid on Friday the twenty fifth day of July next and then and / there traverse and plead to the said presentment or inquisition and in default of any / such traverse or plea being entered or of any evidence being offered to impugn the / liability of the persons named in the said Schedule to contribute to the expenses of the / siad intended new works in the manner therein mentioned a rate will be made on / such Persons in respect of the Estates and in the proportions set opposite and following / their respective names in the said Schedule to the said Inquisition or Presentment / annexed - Dated this second day of June one thousand eight hundred and thirty / four

By order of the Court

Gabriel J Poole} Clerks
Thos Conway Robins }

Notices attached point to these having been physically posted on the church doors at
Kenn, Kingston Seymour and Yatton, e.g.

June 8th 1834

Affixed a notice of which
the within is a true copy on
the Church door of Kingston
Seymour

John Baker Jr

June 15th 1834

Attended at Kingston Seymour and saw the
notice above alluded to remaining
affixed on the Church door

John Baker Jr